

PRODUCT NUMBER
SEE TABLE

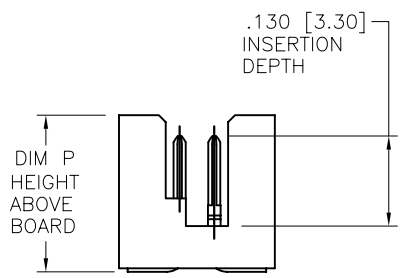
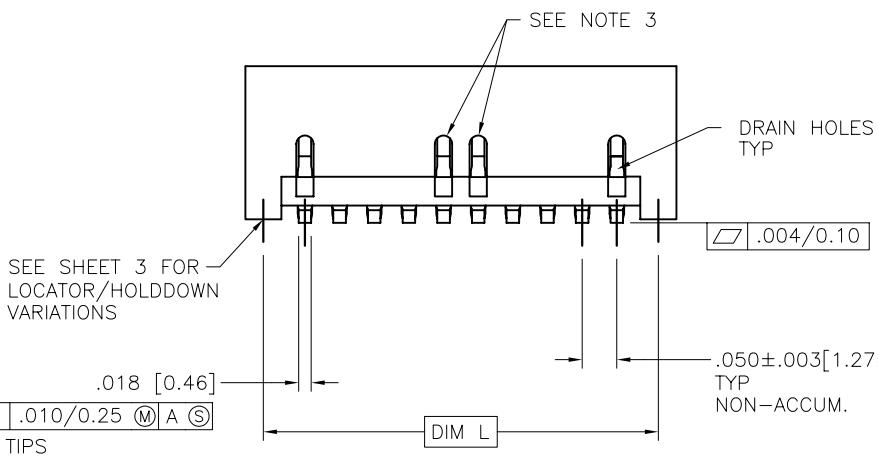
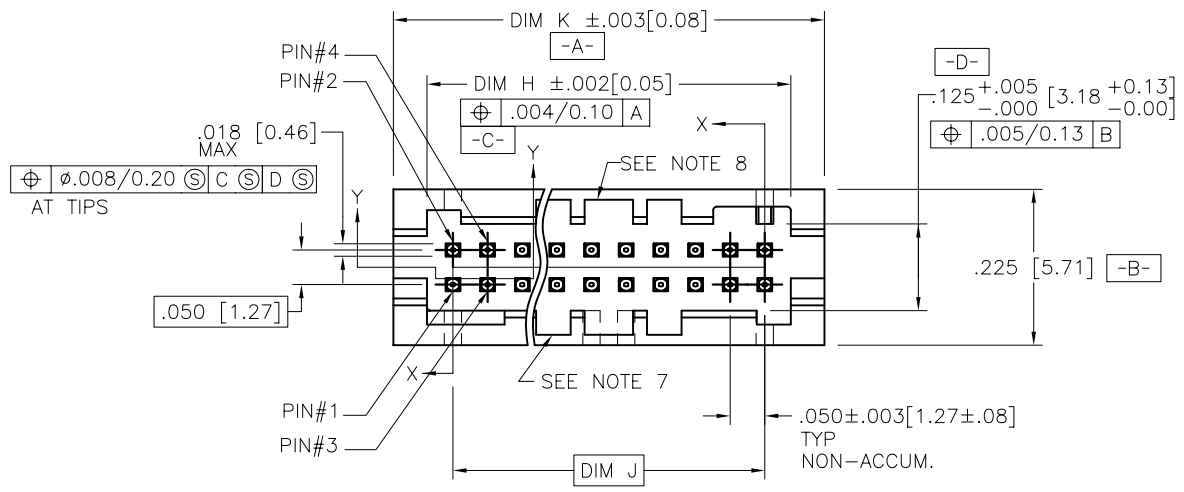

Copyright FCI

mat'l. code		surface		tolerance		projection		product family	
SEE NOTES		ISO 1302		ISO 406		ISO 1101		RIB CAGE	
ltr	ecn no	dr	date	tolerances unless otherwise specified		INCH/MM		title	
T	v10994	CRG	3/15/01	angles	linear	.XX ±.01/XX±.3		RIB CAGE III SMT	
U	v11295	CRG	4/25/01			.XXX±.005/XX±0.13		VERT. HEADER ASS'Y	
V	v10329	CRG	6/06/01	σ±2'		.XXXX±.0020/XXX±0.051		scale 1:1	
W	v04-0004	DAI	1/21/04	dr	M. CORNMAN	6/07/95		dwg no	
X	M05-0084	MHT	5/05/05	engr	D. WHITING	6/07/95		sheet 1 of 6 size	
Y	M06-0284	AEA	7/27/06	chr	D. WHITING	6/07/95		95781 A3	
AA	M08-0245	MHT	8/27/08	appd	D. WHITING	6/07/95		type Product Customer Drawing	
sheet	revision	AA	AA	AA	AA	AA	AA		
index	sheet	1	2	3	4	5	6		

PRODUCT NUMBER
SEE TABLE

SIZE	DIM H	DIM J	DIM K	DIM L
2X5	.275/6.99	.200/5.08	.372/9.45	.320/8.13
2X10	.525/13.34	.450/11.43	.622/15.80	.570/14.48
2X15	.775/19.68	.700/17.78	.872/22.15	.820/20.83
2X20	1.025/26.03	.950/24.13	1.122/28.50	1.070/27.18
2X25	1.275/32.38	1.200/30.48	1.372/34.85	1.320/33.53
2X30	1.525/38.74	1.450/36.83	1.622/41.20	1.570/39.88
2X35	1.775/45.08	1.700/43.18	1.872/47.55	1.820/46.23
2X40	2.025/51.43	1.950/49.53	2.122/53.90	2.070/52.58
2X45	2.275/57.78	2.200/55.88	2.372/60.25	2.320/58.93
2X50	2.525/64.14	2.450/62.23	2.622/66.60	2.570/65.28

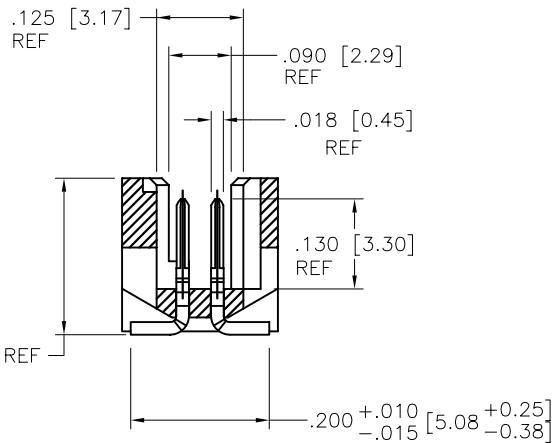

SECTION X-X
ROTATED 90° CW

⊕ .010/.25 ⊙ B

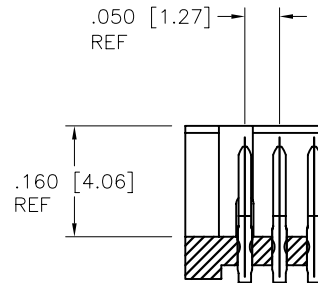

SECTION Y-Y

mat'l. code SEE NOTES		surface ISO 1302	tolerance ISO 406 ISO 1101	projection INCH/MM	product family RIB CAGE
ltr	ecn no	dr	date	tolerances unless otherwise specified	title
AA				angles linear XX ±01/XX±0.3 XXX±.005/XX±0.13 XXXXX±.0020/XXX±0.051	RIB CAGE III SMT VERT. HEADER ASS'Y
				σ±2'	scale 1:1
		dr	M. CORNMAN	6/07/95	dwg no
		enr	D. WHITING	6/07/95	95781
		chr	D. WHITING	6/07/95	sheet 2 of 6 size
		appd	D. WHITING	6/07/95	A3
sheet	revision				type
index	sheet				Product Customer Drawing

PRODUCT NUMBER
SEE TABLE

LOCATOR/HOLDDOWN VARIATIONS

STYLE 1

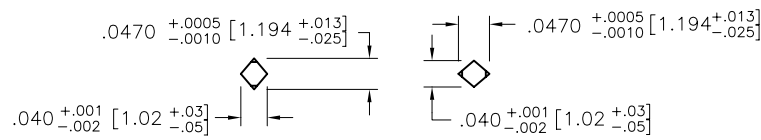
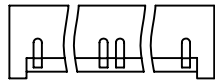

STYLE 2

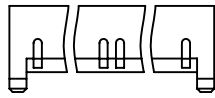

$\phi .0520$ [1.321]
 $\phi .004/0.10$ (M) A (S) B (S) (ALL PEG CONFIGURATIONS)

STYLE 6
SEE NOTE 9

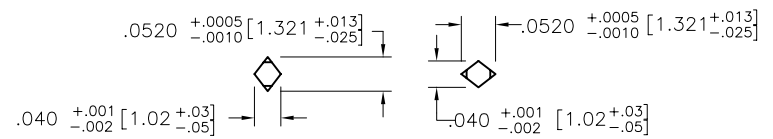
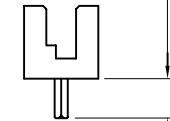
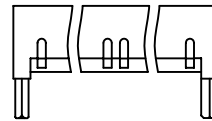

STYLE 3

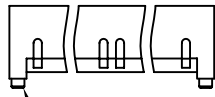

R.0050 [0.127]
 $\phi .0394$ [1.000]
.028 [0.71]
.024 [0.61]

STYLE 7

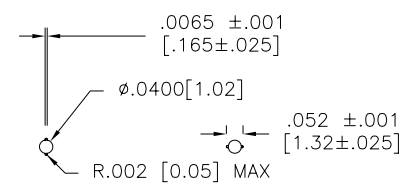
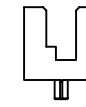
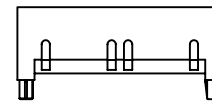

STYLE 4

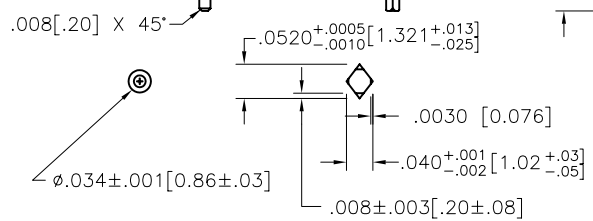
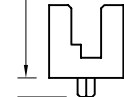
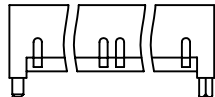

mat'l. code		surface		tolerance		projection		product family	
SEE NOTES		ISO 1302		ISO 406		ISO 1101		RIB CAGE	
ltr	ecm no	dr	date	tolerances unless otherwise specified		INCH/MM		title	
AA				angles	linear	.XX ±.01/XX±.03		RIB CAGE III SMT	
				$\sigma \pm 2'$.XXX±.005/XX±0.13		VERT. HEADER ASS'Y	
						.XXXX±.0020/XXX±0.051		scale 1:1	
		dr	M. CORNMAN	6/07/95				dwg no	
		engr	D. WHITING	6/07/95	sheet 3 of 6 size				
		chr	D. WHITING	6/07/95	95781				
		appd	D. WHITING	6/07/95	A3				
sheet		revision				type		Product Customer Drawing	
index		sheet							

PRODUCT NUMBER
SEE TABLE

RECOMMENDED PCB MOUNTING PAD PATTERN

STYLE
1

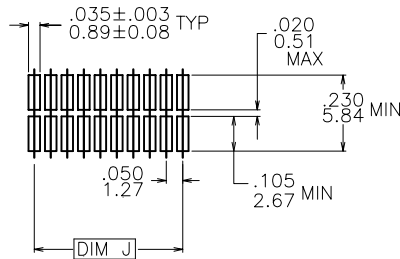

STYLE
2

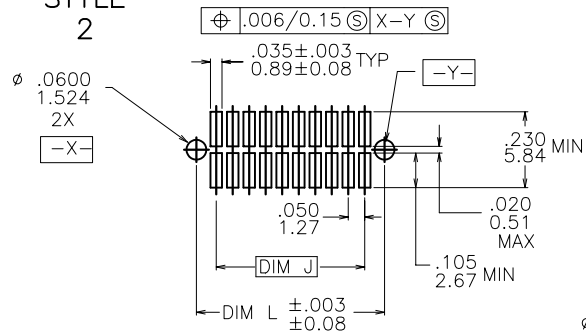

STYLE
3

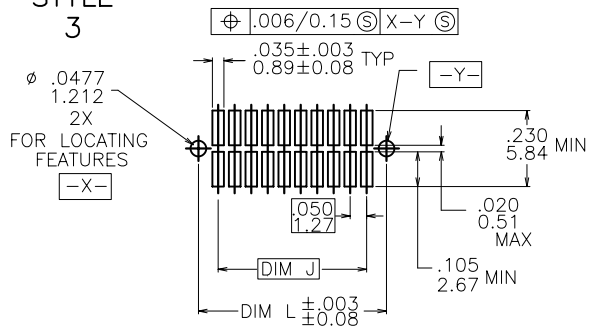

STYLE
5

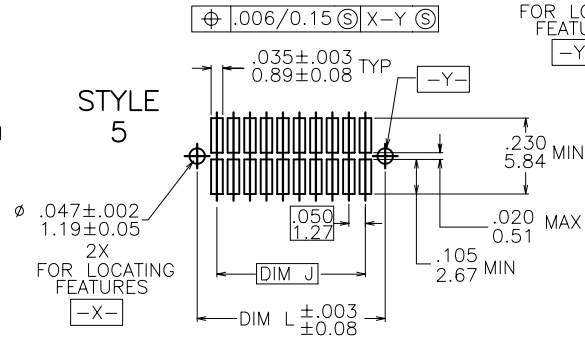

STYLE
7

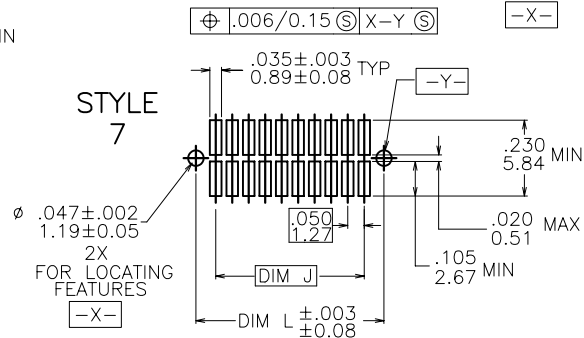

STYLE
4

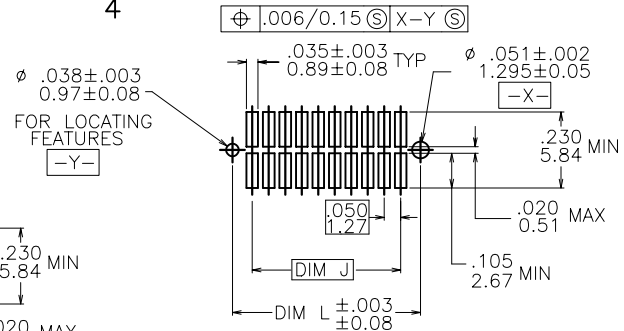

STYLE
6

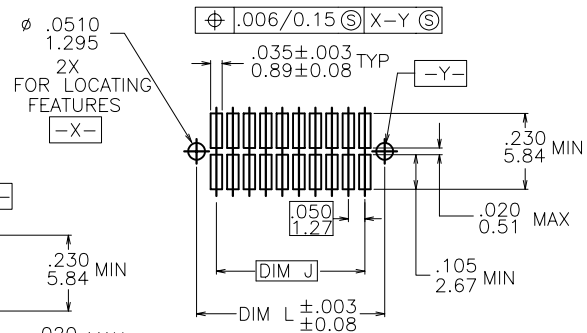

Copyright FCI

mat'l. code SEE NOTES		surface ISO 1302	tolerance ISO 406 ISO 1101	projection INCH/MM	product family RIB CAGE
ltr	ec'n no	dr	date	title RIB CAGE III SMT VERT. HEADER ASS'Y	
AA				linear XX ± 01/XX ± 0.3 XXX ± 005/XXX ± 0.13 XXXX ± 0020/XXXX ± 0.051	scale 1:1
		dr	M. CORNMAN	6/07/95	dwg no
		engr	D. WHITING	6/07/95	sheet 4 of 6 size
		chr	D. WHITING	6/07/95	95781
		appd	D. WHITING	6/07/95	A3
sheet	revision				type Product Customer Drawing
index	sheet				

PRODUCT NUMBER NOTE 1,4A & 4B	DIM P HEIGHT ABOVE BOARD (REF.)	HOLDDOWN STYLE
72428-1XX	.244/6.20	1
73546-1XX	.364/9.25	1
73547-1XX	.364/9.25	2
73548-1XX	.364/9.25	4
84700-1XX	.226/5.74	7
84701-1XX	.298/7.57	7
84734-1XX	.364/9.25	7
87401-1XX	.226/5.74	6
87409-1XX	.226/5.74	2
87849-1XX	.226/5.74	1
88566-1XX	.260/6.60	2
90098-1XX	.298/7.57	2
90863-1XX	.226/5.74	1
91036-1XX	.364/9.25	5
91423-1XX	.226/5.74	2
91855-1XX	.226/5.74	5
92099-1XX	.226/5.74	4
92412-1XX	.298/7.57	4
93206-1XX	.226/5.74	3
93221-1XX	.298/7.57	1
93289-1XX	.298/7.57	5

TABLE A

* CUSTOMER SPECIAL

SEE NOTE 10

*

NOTES:

- ① XXXX-XXXLF
LEAD FREE OPTION (NOTE 11& 13)
NUMBER OF POSITIONS (NOTE 2)
- ② NUMBER OF POSITIONS = 05 THRU 50 IN 5 POS INCREMENTS.
(EXAMPLE : 105=10 POS., 110=20 POS. ETC.)
- ③ REQUIRED ON -X40,-X45 & -X50 POSITION PARTS ONLY.
- 4. PACKAGING :
A. ANTISTATIC TUBES. SEE TABLE A
B. ADD "CT" TO END OF DASH NUMBER FOR CONNECTOR WITH VACUUM CAP IN ANTISTATIC TUBES.
EX. : XXXX-1XXCT
C. PRESSURE SEALED TAPE AND REEL. SEE TABLE C FOR AVAILABLE PART NUMBERS.
- ⑤ HOUSING MATERIAL :
GLASS FILLED THERMOPLASTIC FLAME RETARDANT PER UL 94V-0.
COLOR : BLACK
- ⑥ TERMINAL PLATING :
30u"/.76u HARD Au OVER 50u"/1.27u Ni ON CONTACT ZONES.
100u"/2.54u TIN LEAD OVER 50u"/1.27u Ni IN SOLDERING ZONES.
LEAD FREE OPTION:
30u"/.76u HARD Au OVER 50u"/1.27u Ni ON CONTACT ZONES.
100u"/2.54u PURE TIN OVER 50u"/1.27u Ni IN SOLDERING ZONES.
- ⑦ MOLDING FLOW RESTRICTOR QUANTITY AND LOCATION IS MANUFACTURING OPTION.
- ⑧ VACUUM CAP SLOT REQUIRED ON ALL SIZES, SLOT MAY BE LOCATED ON OPPOSITE SIDE FOR 2 X 5.
- ⑨ STYLE 6 IS NOT AVAILABLE IN TAPE AND REEL.
- ⑩ 90863-1XX IS PACKAGED ONLY IN TAPE AND REEL.
- ⑪ ADD LF SUFFIX AT THE END OF PART NUMBER FOR LEAD FREE OPTION.
- 12. THE HOUSING WILL WITHSTAND EXPOSURE TO 260°C PEAK TEMPERATURE FOR 20 SECONDS IN A CONVECTION, INFRA-RED OR VAPOR PHASE REFLOW OVEN. SEE APPLICATION NOTE/PROCEDURES IF THEY ARE AVAILABLE.
- ⑬ THIS PRODUCT MEETS EUROPEAN UNION DIRECTIVES AND OTHER COUNTRY REGULATION AS DESCRIBED IN GS-22-008.

mat'l. code SEE NOTES		surface ISO 1302	tolerance ISO 406 ISO 1101	projection 	product family RIB CAGE
ltr	ecn no	dr	date	tolerances unless otherwise specified	title
AA				angles linear XX ±01/XX±0.3 .XXX±.005/XX±0.13 .XXXX±.0020/XXX±0.051	RIB CAGE III SMT VERT. HEADER ASS'Y
				σ±2'	INCH/MM scale 1:1
		dr	M. CORNMAN	6/07/95	dwg no
		enr	D. WHITING	6/07/95	sheet 5 of 6 size
		chr	D. WHITING	6/07/95	95781
		appd	D. WHITING	6/07/95	A3
sheet	revision				type
index	sheet				Product Customer Drawing

PRODUCT NUMBER NOTE 11,4C	QTY. REEL	TAPE WIDTH PITCH MM	CONNECTOR ORIENTATION IN TAPE POCKET
72428-120TR	500	44/12	VIEW 1
73547-110TR		24/12	
84700-105TR		24/12	
84700-135TR		56/12	
87409-115TR		44/12	
87409-120TR		44/12	
87409-125TR		56/12	
87409-130TR		56/12	
87409-140TR		72/12	
87849-110TR		24/12	
87849-115TR		44/12	
87849-120TR		44/12	
87849-125TR		56/12	
87849-130TR	500	56/12	
88566-110TR	750	24/12	
88566-115TR	500	44/12	
88566-130TR	500	56/12	
90863-110		24/12	
90863-115		44/12	VIEW 1
90863-115REV		44/12	VIEW 2 *
90863-120		44/12	VIEW 1
90863-125		56/12	
90863-130		56/12	
91036-110P		24/16	
93206-115TR		44/12	
93221-105TR		24/12	
93221-110TR		32/12	
93221-125TR	500	56/12	VIEW 1

TABLE C

* CUSTOMER SPECIAL
NO VACUUM CAP

REFERENCE ONLY :

TAPE WIDTH 32mm AND ABOVE HAS BOTH FEED TRACKS,
BELOW 32mm HAS TOP FEED TRACK ONLY.

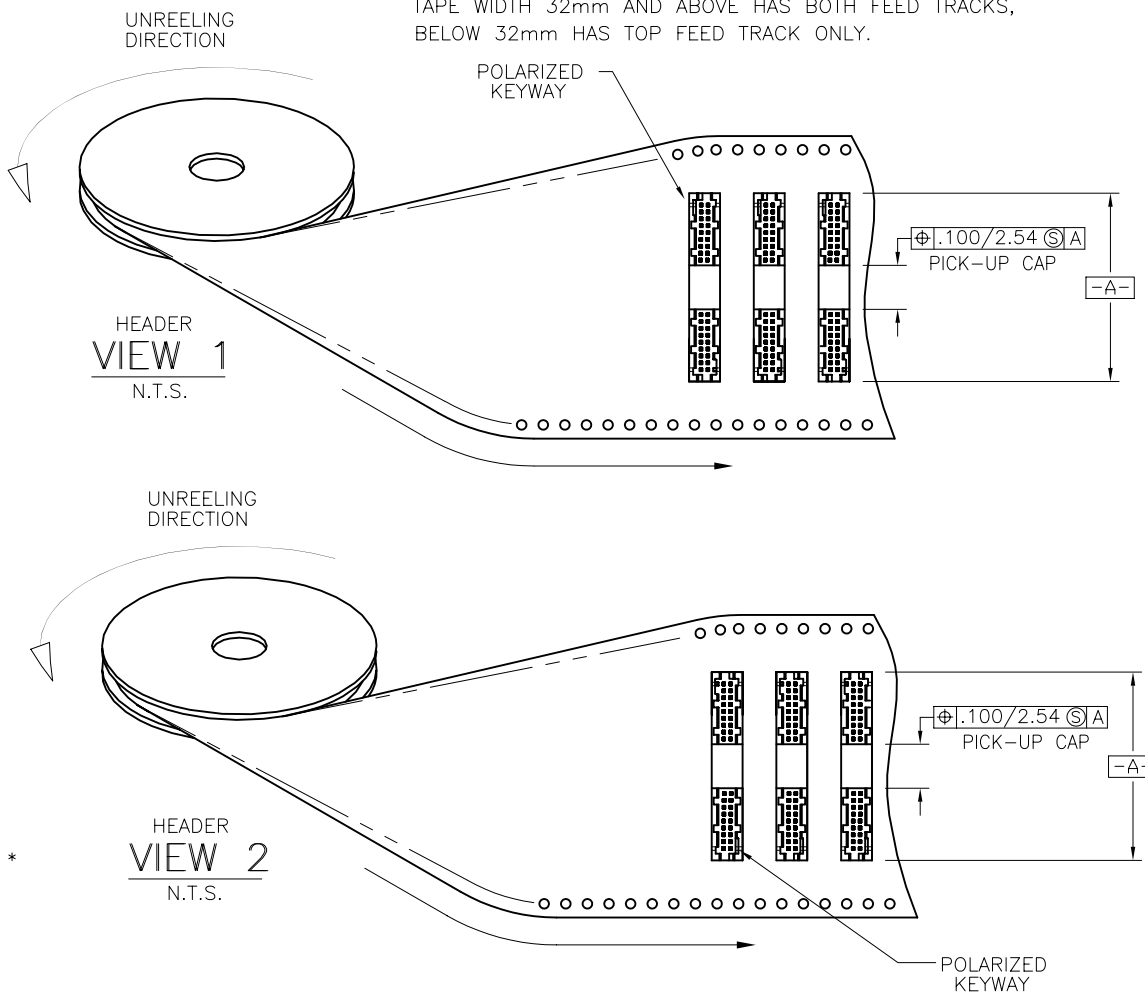

mat'l. code SEE NOTES		surface ISO 1302	tolerance ISO 406 ISO 1101	projection 1st angle	product family RIB CAGE
ltr	ec'n no	dr	date	tolerances unless otherwise specified	title
AA				angles linear XX ±.01/XX±0.3 XXX±.005/XX±0.13 XXXX±.0020/XXX±0.051	RIB CAGE III SMT VERT. HEADER ASS'Y
				σ±2'	INCH/MM scale 1:1
		dr	M. CORNMAN	6/07/95	dwg no
		engr	D. WHITING	6/07/95	95781
		chr	D. WHITING	6/07/95	sheet 6 of 6 size A3
		appd	D. WHITING	6/07/95	type Product Customer Drawing
sheet index	revision sheet				